

MICROFILMED

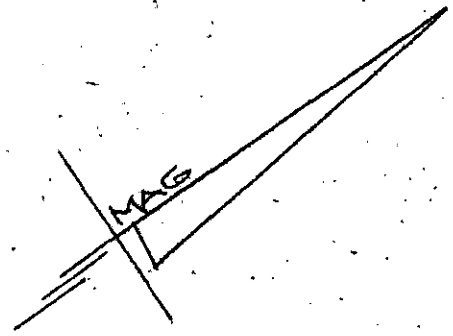
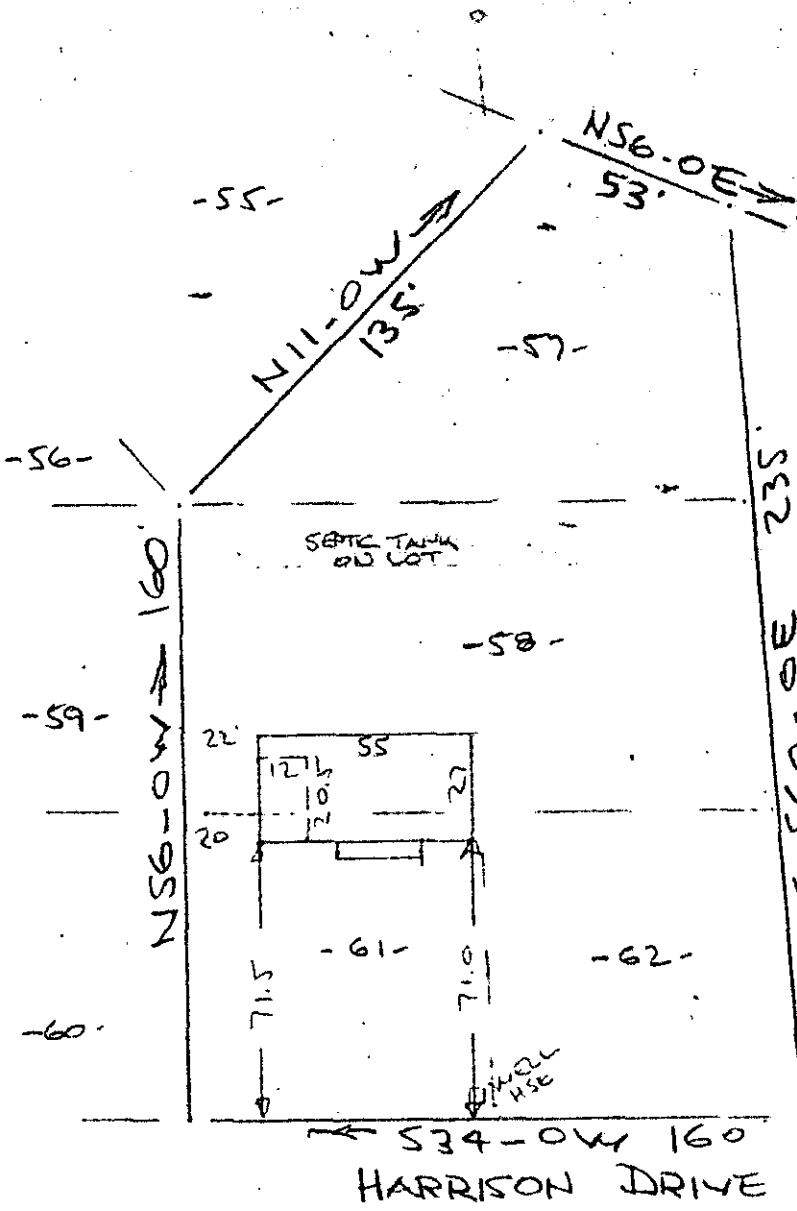

26956

PROPERTY OF
 JERRY LEE OTIS WHARTON & PEGGY M. WHARTON
 HEAR, GREENVILLE, S. C.
 SCALE: 1" = 40' 7 MAY 1975

This is to certify that on the 7th day of May 1975, I surveyed the property shown on this plat, being known as lots 57, 58, 61 and 62 on plat of Howard Heights and PROPERTY OF JERRY LEE OTIS WHARTON & PEGGY M. WHARTON and recorded in the RMC Office Greenville County, S. C., in Plat Book _____ at Page _____; and that the property lines, walls and buildings are as shown hereon, and that the walls and buildings located on said lot do not encroach or project on adjacent street or property, and that no adjacent walls or buildings encroach or project on said premises, and no power lines cross this property except as shown hereon.

FILED
 GREENVILLE CO. S. C.
 MAY 20 9 41 AM '75
 DORRIS STANKERSLE
 R.M.C.

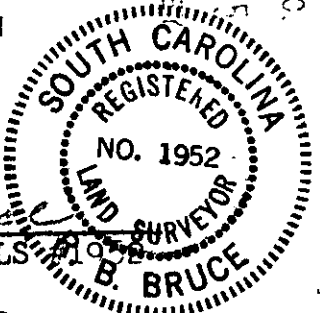

R. B. Bruce, RLS
 R. E. Bruce, RLS

RECORDING FEE
 PAID \$ 1.00

✓ 5M-19

CAROLINA SURVEYING CO.
 112 Manly St.
 Greenville, S. C.

MAY 20 1975

141/68